

SE 1/4 SW 1/4 of S10-T16N-R10W
Approximately 1 Acre



North Logan Cemetery

Established 1910
Highway 281 and 23rd Avenue
Howard County Nebraska



Owned and Maintained
North Logan Cemetery Association

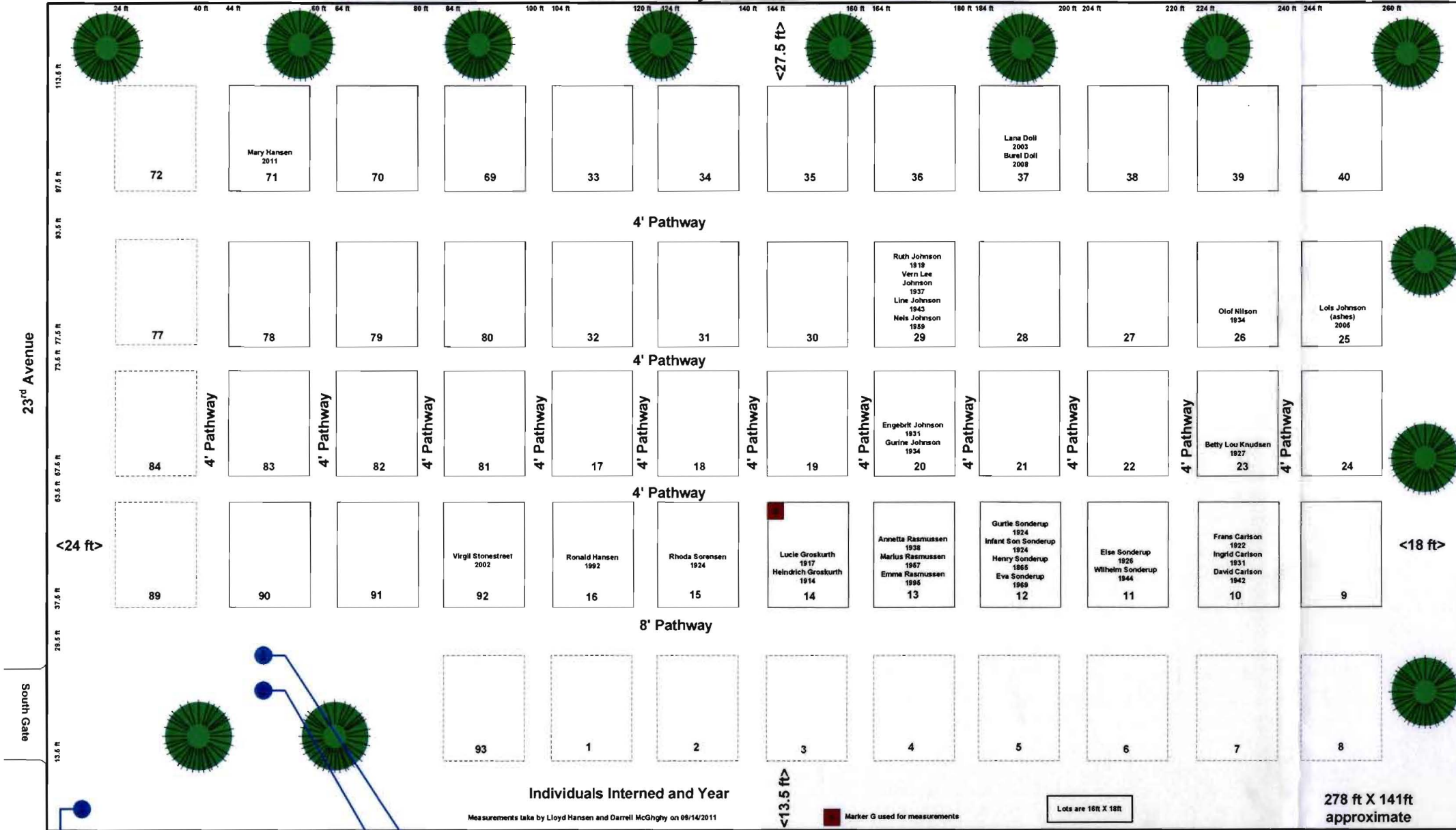

CHG PAID 5.50 ck FEE BOOK

STATE OF NEBRASKA SS. 1559
HOWARD COUNTY FILED FOR RECORD
MO Nov DAY 29 20 11
AT 8:31 O'CLOCK A.M. RECORDED
IN BOOK 11 OF RECORD PAGE 2284
Marge Palenberg COUNTY CLERK BY 813

U. S. Coast & Geodetic Survey
Bench Marker
A118/1935

East Gate

Church Marker

Date of Diagram
09/15/2011
Not to Scale

Highway 281

On September 6, 1910 the original 2 acres were deeded in the records of Howard County Nebraska in Book 7 Page 115 and conveyed to the St. Peter Danish Evangelical Lutheran Congregation of Logan Precinct. A church was erected and a pioneer cemetery established. In 1950 the former members of said church held a meeting to dissolve said church. In 1951 the former members of said church formed the North Logan Cemetery Association and retained 1 acre of land and deeded the other 1 acre to Henry Sonderup. Said church was moved to Ord, Nebraska. The Sonderup family originally deeded the 2 acres to said church in 1910.